

AC SOCKET

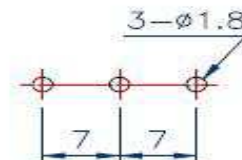

SS-120-C-PCB-A

STANDARD: IEC 320 C14
 RATING: 15A/250V AC
 APPROVALS: UL/CSA
 RATING: 10A250V ~
 APPROVALS: VDE/SEV/DEMKO/
 NEMKO/ SEMKO/FIMKO/CCEE

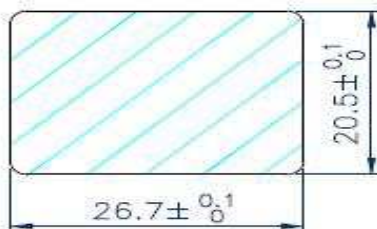
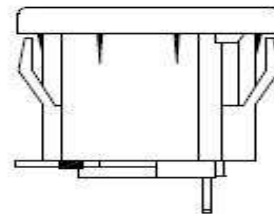
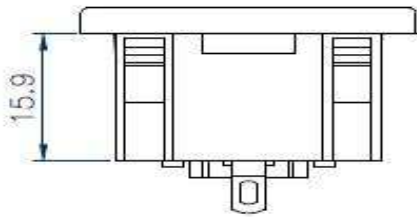
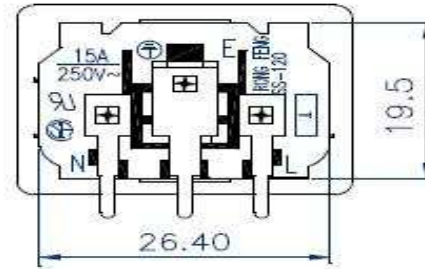
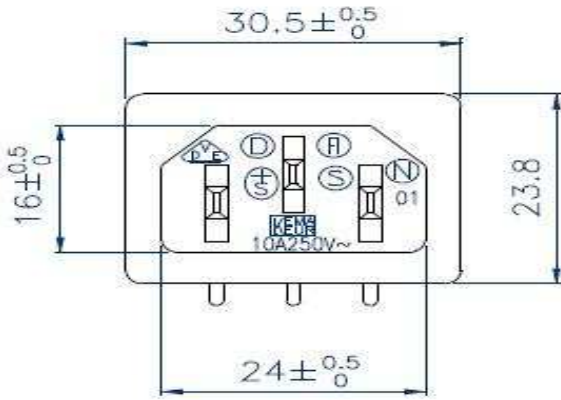

PANEL CUTOUT
 THICKNESS 0.8mm~1.5mm

P.C.B LAYOUT